

Segurança e conforto na arquitetura para saúde

Avaliações, reflexões e perspectivas a partir da IFHE RIO 2017



ABDEH

Associação
Brasileira para o
Desenvolvimento do
Edifício
Hospitalar



Associação
Brasileira para o
Desenvolvimento do
Edifício
Hospitalar



Segurança e conforto na arquitetura para saúde

Avaliações, reflexões e perspectivas a partir da IFHE RIO 2017

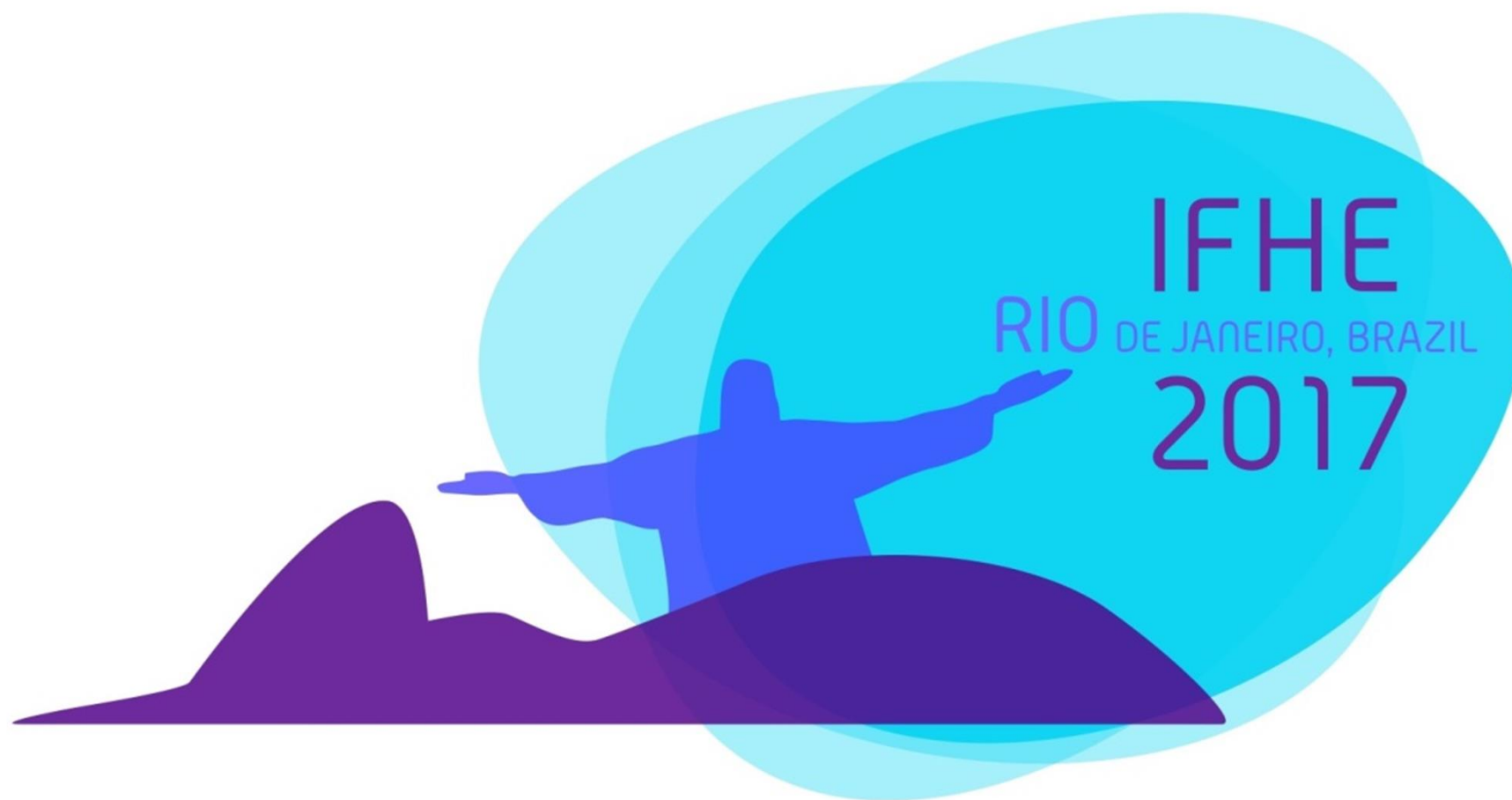

Associação
Brasileira para o
Desenvolvimento do
Edifício
Hospitalar



IFHE – International Federation of Healthcare Engineering 1986 -2016

32 Years Turning Around the World



IFHE – International Federation of Healthcare Engineering 1986 -2016

1988



IFHE NATIONAL ASSOCIATIONS IN LATIN AMERICA

IFHE – International Federation of Healthcare Engineering 1986 -2016

1994



IFHE NATIONAL ASSOCIATIONS IN LATIN AMERICA

IFHE – International Federation of Healthcare Engineering 1986 -2016

2014



IFHE NATIONAL ASSOCIATIONS IN LATIN AMERICA

IFHE – International Federation of Healthcare Engineering 1986 -2016

2018



IFHE NATIONAL ASSOCIATIONS IN LATIN AMERICA

INTERNATIONAL FEDERATION OF HOSPITAL ENGINEERING

IFHE 2014 – 2016



EXECUTIVE COMMITTEE
ExCo



**COUNCIL OF
ASSOCIATIONS**

2014 – 2016

Presidente	Liliana Font	- Argentina
Secretário Geral	Gunnar Baekken	- Noruega
Secretário assistente	Ronnie Brown	- Reino Unido
1º Vice-Presidente	Douwe Kiestra	- Netherlands
2nd Vice-Presidente	Darryl Pitcher	- Austrália
Presidente Anterior	Ole Rist	- Noruega
Tesoureiro	Steve Drinkow	- África do Sul
Conselheiro	Fábio Bitencourt	- Brasil
Conselheiro	Steve Rees	- Canadá
Conselheiro	Christian Bender	- Alemanha

**INTERNATIONAL FEDERATION OF
HOSPITAL ENGINEERING - IFHE**

Associação
Brasileira para o
Desenvolvimento do
Edifício
Hospitalar

ABDEH



INTERNATIONAL FEDERATION OF HOSPITAL ENGINEERING

IFHE 2014 – 2016



EXECUTIVE COMMITTEE ExCo

Presidente
Secretário Geral
Secretário assistente
1º Vice-Presidente
2nd Vice-Presidente
Presidente Anterior
Tesoureiro
Conselheiro
Conselheiro
Conselheiro

Liliana Font
Gunnar Baekken
Ronnie Brown
Douwe Kiestra
Darryl Pitcher
Ole Rist
Steve Drinkow
Fábio Bitencourt
Steve Rees
Christian Bender

- Argentina
- Noruega
- Reino Unido
- Netherlands
- Austrália
- Noruega
- África do Sul
- Brasil
- Canadá
- Alemanha



**INTERNATIONAL FEDERATION OF
HOSPITAL ENGINEERING - IFHE**

Associação
Brasileira para o
Desenvolvimento do
Edifício
Hospitalar

ABDEH



INTERNATIONAL FEDERATION OF HOSPITAL ENGINEERING

IFHE 2016 – 2018



EXECUTIVE COMMITTEE ExCo

2016 – 2018

Presidente	Douwe Kiestra	- Netherlands
Secretário Geral	Gunnar Baekken	- Norway
Secretário assistente	Andy Wavell	- United Kingdom
1º Vice-Presidente	Darryl Pitcher	- Australia
2nd Vice-Presidente	Daniella Pedrini	- Italy
Presidente Anterior	Liliana Font	- Argentina
Tesoureiro	Steve Drinkow	- South Africa
Conselheiro	Fábio Bitencourt	- Brasil
Conselheiro	Steve Rees	- Canada
Conselheiro	Christian Bender	- Alemanha
Conselheiro	Walt Vernon	- USA
Conselheiro	Hirayama Yoshihisa	- Japan

Saíram em 2016

Presidente 2012/4 Ole Rist - Noruega

Secretário assistente Ronnie Brown - UKingdom

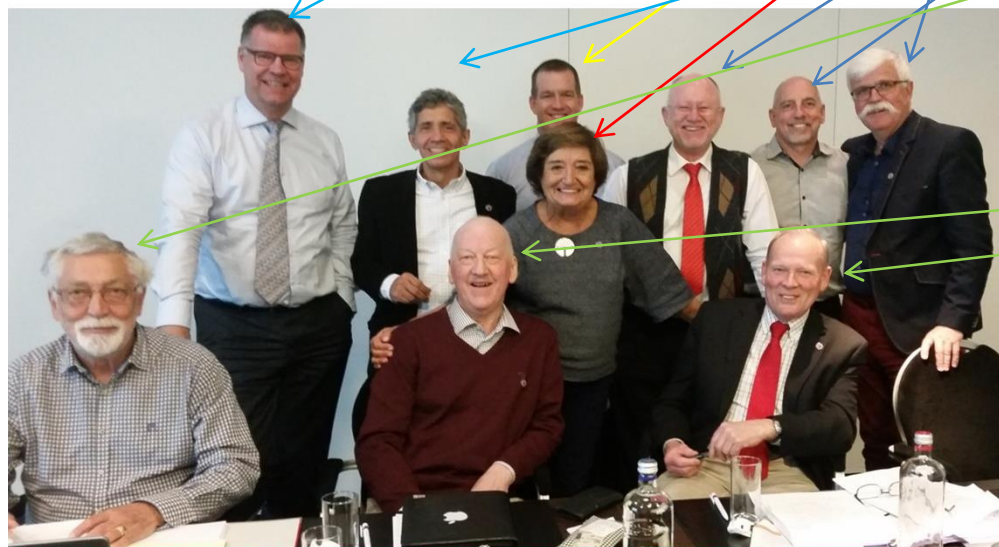

Associação
Brasileira para o
Desenvolvimento do
Edifício
Hospitalar

ABDEH

INTERNATIONAL FEDERATION OF
HOSPITAL ENGINEERING - IFHE



INTERNATIONAL FEDERATION OF HOSPITAL ENGINEERING IFHE

EXECUTIVE COMMITTEE
ExCo

**COUNCIL OF
ASSOCIATIONS**

Ano	Local	Evento
2014	Buenos Aires - Argentina	23th IFHE Congress ExCo and Council Meeting
2015	Turku – Finlandia	VI EU Congress ExCo and Council Meeting
2016	Den Haag – Netherlands/Holanda	24th IFHE Congress ExCo and Council Meeting
2017	Rio de Janeiro - Brazil	International Seminar IFHE RIO 2017 ExCo and Council Meeting
2018	Brisbane - Australia 6 a 11 outubro	25th IFHE Congress ExCo and Council Meeting
2019	Manchester - United kingdom 7 a 9 outubro	ExCo and Council Meeting IFHE Europe Conference
2020	Roma – Italia	26th IFHE Congress ExCo and Council Meeting

Associação
Brasileira para o
Desenvolvimento do
Edifício
Hospitalar

ABDEH



INTERNATIONAL FEDERATION OF HOSPITAL ENGINEERING - IFHE

Buenos Aires - Argentina - 2015



INTERNATIONAL FEDERATION OF
HOSPITAL ENGINEERING - IFHE

Associação
Brasileira para o
Desenvolvimento do
Edifício
Hospitalar

ABDEH





INTERNATIONAL FEDERATION OF HOSPITAL ENGINEERING - IFHE

The Hague – Netherlands - 2016



INTERNATIONAL FEDERATION OF
HOSPITAL ENGINEERING - IFHE

Associação
Brasileira para o
Desenvolvimento do
Edifício
Hospitalar

ABDEH



INTERNATIONAL FEDERATION OF HOSPITAL ENGINEERING - IFHE Rio de Janeiro - Brazil - 2017



INTERNATIONAL FEDERATION OF
HOSPITAL ENGINEERING - IFHE

Associação
Brasileira para o
Desenvolvimento do
Edifício
Hospitalar

ABDEH



INTERNATIONAL FEDERATION OF HOSPITAL ENGINEERING - IFHE Buenos Aires – Argentina 2014



Meeting – IFHE American Regional Group - April 2016
INTERNATIONAL FEDERATION OF HOSPITAL ENGINEERING - IFHE

Associação
Brasileira para o
Desenvolvimento do
Edifício
Hospitalar

ABDEH



INTERNATIONAL FEDERATION OF HOSPITAL ENGINEERING - IFHE

The Hague – Netherlands



I Meeting – IFHE American Regional Group - April 2016
INTERNATIONAL FEDERATION OF HOSPITAL ENGINEERING - IFHE

Associação
Brasileira para o
Desenvolvimento do
Edifício
Hospitalar

ABDEH



INTERNATIONAL FEDERATION OF HOSPITAL ENGINEERING
IFHE
Rio de Janeiro - Brazil



II Meeting – IFHE American Regional Group - August 2018
INTERNATIONAL FEDERATION OF HOSPITAL ENGINEERING - IFHE

Associação
Brasileira para o
Desenvolvimento do
Edifício
Hospitalar

ABDEH



En el marco del 8° CONGRESO DE INFRAESTRUCTURA HOSPITALARIA
que se desarrollará en Santiago de Chile los días 4,5 y 6 Septiembre
de 2018 se realizará el:



IFHE



III ENCUESTRO DEL GRUPO AMERICANO IFHE **III IFHE'S AMERICAN GROUP MEETING**

Martes 4 de Septiembre 2018, a las 19:00 hrs.
En CentroParque, Av. Pdte. Riesco 5330, Las Condes, Santiago de Chile.
Confirma tu asistencia en aarqhos@aarqhos.cl

*Encuentro exclusivo para Delegaciones Americanas IFHE

III Meeting – IFHE American Regional Group - August 2018
INTERNATIONAL FEDERATION OF HOSPITAL ENGINEERING - IFHE

Associação
Brasileira para o
Desenvolvimento do
Edifício
Hospitalar

ABDEH



1986 - 9th IFHE CONGRESS

Barcelona, España

- Planning
- Construction - Reformation
- Hospital Engineering
- Safety
- Maintenance
- Medical Equipment

« The influence of planning and programming to reduce capital investment and running cost in hospitals »



AADAH – Barcelona Act.
IFHE – AEDIAH



Antonio Bonnin Vila

1988 - 10th IFHE CONGRESS

- Environmental
- Productivity
- Retrofit
- Services

Edmonton, Alberta, Canada

- Computers
- Standard
- Energy

« Hospital Engineering to the Year 2001 » E. Caetano

- More extensive preventive medicine
- Larger ambulatory activity
- Domiciliary services and day hospitals



« In management terms, the only constant factor is change » D. Hanson
IFHE – CHES Steve Morawski

1990 - 11th IFHE CONGRESS

London, UK

- Energy
- Special needs of Developing Countries
- Planning and Design
- Estate Care and Maintenance
- Health and Safety
- Specialized Hospital Equipment

« The changing scene of health care and technology »



Twentieth Anniversary of IFHE, a special occasion to review the developments in Health Care Technologies

IFHE – IHE

Basil Hermon

1992 - 12th IFHE CONGRESS

- Flexibility and restructuring
- Prevention and Safety

Exhibition Hospital 92

«In 1492 Colon discovers a new Continent»

«In 1992 Bologna the Hospital Planet»

Bologna, Italia



IFHE – FE.NA.T.O

Alberto Lena

1994 - 13th IFHE CONGRESS

- Healthcare policy and needs in SA
- Primary care facilities
- Standards

Cape Town, South Africa

- Equipment maintenance, staff training and maintenance management
- The role of the private sector

« Hospital Design and Engineering in a First and Third World Context »



1996 - 14th IFHE CONGRESS

Copenhagen, Denmark

First time in Scandinavian

- Welfare policy
- Senior care
- Environment / Energy
- Technical systems
- Service
- Managment



« Scandinavian has, opposite to many other parts of the world, been able to improve the close historical solidarity, by almost pulling down the frontiers between the countries...

especially with respect to Healthcare, Hospital and Senior Citizen Policies»

IFHE – FSD

Erik Ree

1998 - 15th IFHE CONGRESS

Edinburgh, UK

- Healthcare policies and services
- Healthcare buildings
- Operation and Maintenance
- Budgetary constraints
- Environment – Safety
- Energy, alternative sources
- Healthcare issues in developing countries



« ...an occasion to review the many changes in Healthcare Technology and other recent and dramatic economic changes which are having such a marked effect on the way Healthcare is provided...»

IFHE – IHE

Laurence Hadley

2000 - 16th IFHE CONGRESS

Sidney, Australia

- Managing medical equipment in a developing country
- Risk management
- Facility management
- Change / Challenges / Technology
- Environmentally friendly hospital
- Benchmarking

« Healthcare and Facility Management Beyond 2000 »

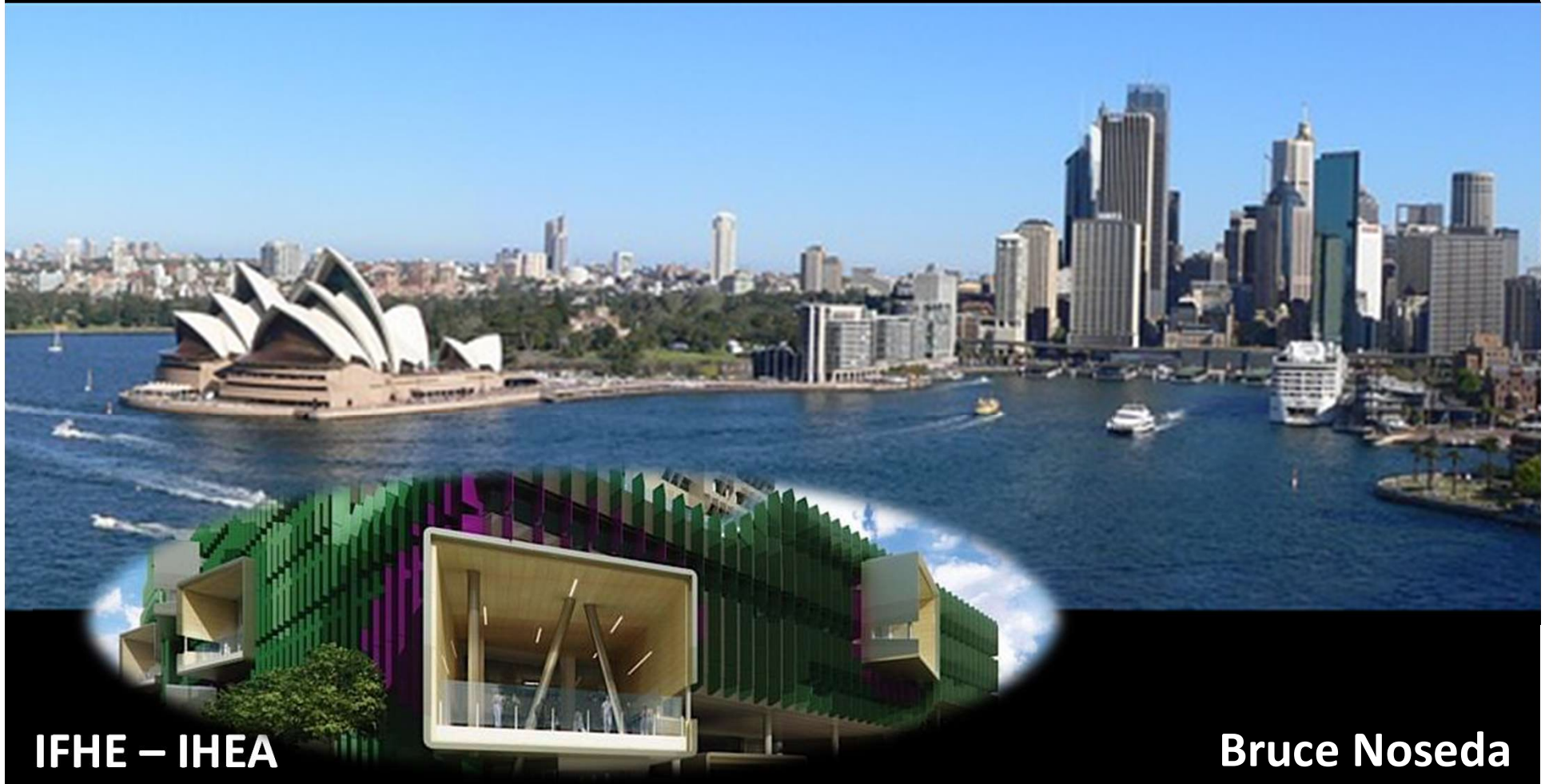

IFHE – IHEA

Bruce Nosedá

2002 - 17th IFHE CONGRESS

Bergen, Norway

- Outsourcing – In house Management in F.M.
- Commissioning strategy
- Reduced running expenses
- Highly integrated system solutions for air conditioned in hospital
- Energy and environment

The new AHUS «Europe's most modern hospital»



IFHE – FSLT

Gunnar Baekken

2004 - 18th IFHE CONGRESS

Orlando, USA



IFHE – ASHE



Dennis Grady

2006 - 19th IFHE CONGRESS

Cape Town, South Africa

- The principle of integrated design by improved collaboration, amongst the professions
- The more efficient management of planning operation, maintenance and safety
- The advancement of education of personal



IFHE – SAFHE

Steve Drinkrow

2008 - 20th IFHE CONGRESS

Barcelona, España

« The Hospital Engineering and the Information Technologies »

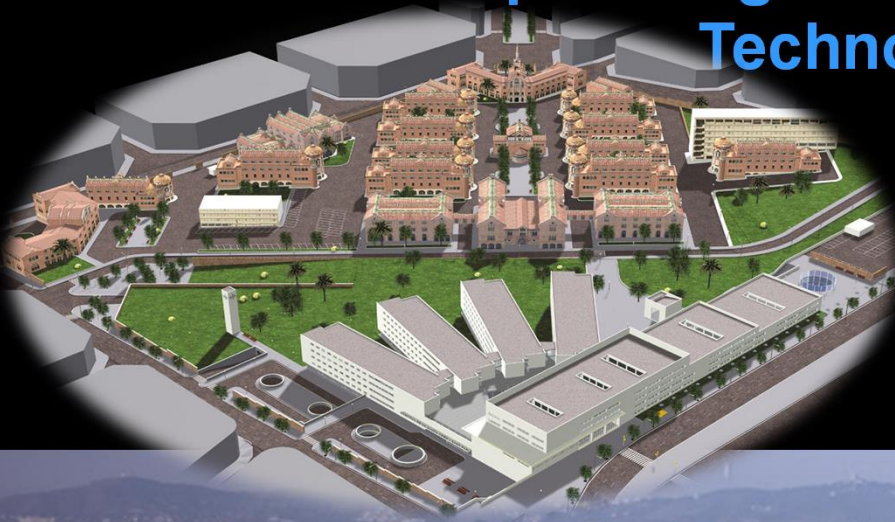

- Control of logistics
- IT and Electrical Safety
- Energy Sustainable Strategies
- Clinic Engineering

An aerial photograph of Barcelona, Spain, showing the city's dense urban landscape, the Mediterranean Sea, and the coastline. The image captures the city's expansion towards the sea, with various buildings and infrastructure visible. The text 'Un gran parc de Salut en el litoral de Barcelona' is overlaid on the lower part of the image.

**Un gran parc de Salut
en el litoral de Barcelona**

IFHE – AEDIAH

Francisco Castella

2010 - 21th IFHE CONGRESS

Tokyo, Japan

- Advances Technologies
- Risk Management
- Facility Management

- Healthy Cities
- Hospital Environment
- Clinical Engineering

« Health care engineering against cultural background »



HOSPEX JAPAN
IFHE – HEAJ

Yasushi Nagasawa

2012 - 22th IFHE CONGRESS

Norway

« A voyage through International and Norwegian Hospitals »

- Use of BI, in Hospital projects
- Identifying Attributes of Hospital Design
- Natural light.
- The relation between people and buildings
- Hospital Technology
- Facility management and administrators



IFHE – FSLT

Ole Rist

2014 - 23th IFHE CONGRESS

Buenos Aires, Argentina

« Health care facilities in times of radical changes»

- Sustainability
- Humanization
- New Scenarios



First Exhibition and Award “To the architectural quality in health buildings”
IFHE – AADAIH

Liliana Font

2016 - 24th IFHE CONGRESS

The Hague, The Netherlands



IFHE 2016

THE NETHERLANDS

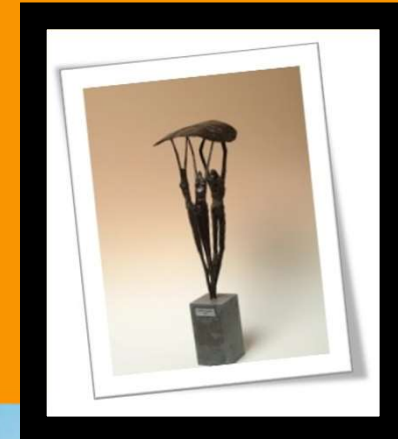

24th Congress of the International Federation of Hospital Engineering (IFHE)
The Hague | 18 - 20 April 2016

« A Healing Environment
for all Users »

IFHE – NVTG



Douwe Kiestra

2018 - 25th IFHE CONGRESS

Australia



IFHE 2018
BRISBANE, AUSTRALIA



25TH CONGRESS OF THE
INTERNATIONAL FEDERATION
OF HOSPITAL ENGINEERING

6-11 OCTOBER 2018

BRISBANE CONVENTION &
EXHIBITION CENTRE



IFHE – IHEA

Darryl Pitcher

2020 - 26th IFHE CONGRESS

Roma Italia



IFHE – SIAIS

Daniella Pedrini



Associação
Brasileira para o
Desenvolvimento do
Edifício
Hospitalar



THANK YOU.
SEE YOU IN RIO!

www.ifherio2017.com

IFHE - INTERNATIONAL SEMINAR | EXCO AND COUNCIL MEETING
Rio de Janeiro, Brazil – August, 2017
Hospital environment for patient and worker safety



Segurança e conforto na arquitetura para saúde

Avaliações, reflexões e perspectivas a partir da IFHE RIO 2017



ABDEH

Associação
Brasileira para o
Desenvolvimento do
Edifício
Hospitalar



Associação
Brasileira para o
Desenvolvimento do
Edifício
Hospitalar

